

INITIAL SPACE SUMMARY

SECTION 3.1.3

(PAGE LEFT INTENTIONALLY BLANK)

PRELIMINARY DESIGN PROGRAM, MARCH 2021

3.1.3 - INITIAL SPACE SUMMARY

- Initial Space Summary
- Existing Floor Plans
- Variations from MSBA Space Guidelines

PRELIMINARY DESIGN PROGRAM, MARCH 2021

(PAGE LEFT INTENTIONALLY BLANK)

(PAGE LEFT INTENTIONALLY BLANK)

3.1.3 - EXISTING FLOOR PLANS



FIRST FLOOR PLAN

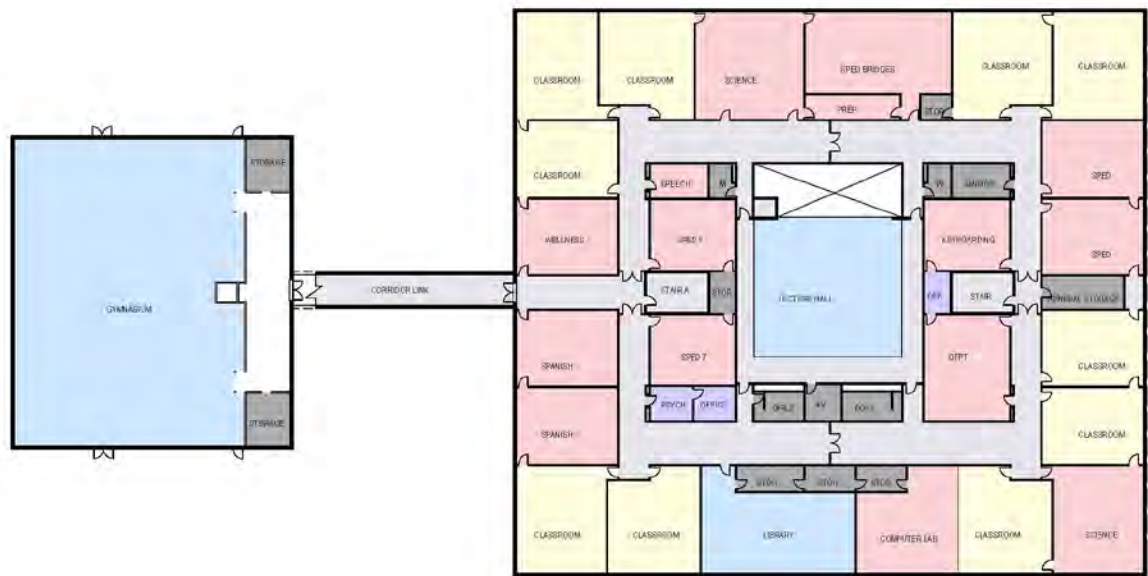

SECOND FLOOR PLAN



3.1.3 - EXISTING FLOOR PLANS

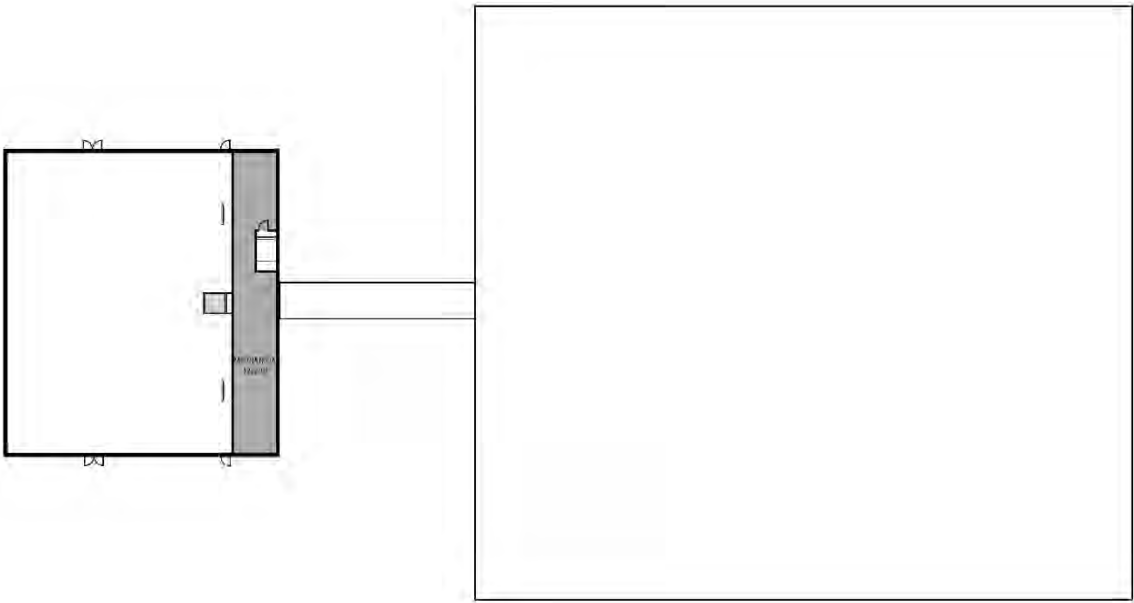

THIRD FLOOR PLAN



PRELIMINARY DESIGN PROGRAM, MARCH 2021

3.1.3 – INITIAL SPACE SUMMARY

As defined in the executed Design Enrollment Certification dated January 2, 2020 (see Appendix 3.1.8.3), the Massachusetts School Building Authority (MSBA) and the Town of Tyngsborough agreed upon design enrollment for the Tyngsborough Middle School to be investigated by this study is a single grade configuration of 480 students to serve grades 6 through 8. For the 2020-2021 school year, the Tyngsborough School District operates the Tyngsborough Middle School with a current enrollment of approximately 391 students serving grades 6 through 8. The Study Enrollment Certification is included in the Appendix and the options outlined in section 3.1.6 reflect that criteria. The following pages contain the detailed Initial Space Summaries for the grade configuration and enrollment the MSBA has authorized the Tyngsborough School District to explore and document.

VARIATIONS FROM MSBA SPACE GUIDELINES

For the Grade 6-8 / 480 student configuration (new), the Proposed Space Summary for new construction totals 72,095 net square feet (nsf) [108,143 gross square feet (gsf) applying a 1.50 grossing factor]. This is 11,260 nsf [16,890 gsf total] larger than the MSBA Guideline of 60,835 nsf [91,252 gsf total] for a middle school of this enrollment size. Based on the District's Educational Program, the differences from the MSBA Guidelines can be attributed as follows

Core Academic Spaces

- Two (2) less General Classroom at 950 nsf each [2,850 gsf total] to accommodate the District's teaming model per grade as noted in the Educational Program.
- One (1) additional STE Rooms – Grades 5-6 at 1,080 nsf each [1,620 gsf total] to accommodate the District's Spanish curriculum as noted in the Educational Program.
- One (1) additional STE Storage at 120 nsf each [180 gsf total] to accommodate the District's Keyboarding program as noted in the Educational Program.
- One (1) additional Science Classroom/Lab – Grades 7-8 at 1,440 nsf each [2,600 gsf total] to accommodate the District's Science curriculum as noted in the Educational Program.
- One (1) additional Prep Room at (200 nsf each) [300 gsf total] to accommodate the District's Science curriculum as noted in the Educational Program.

PRELIMINARY DESIGN PROGRAM, MARCH 2021

Special Education

- One (1) additional Special Education Self-contained Classroom at 1,200 nsf each [1,425 gsf total] to accommodate the District's Special Educational curriculum as noted in the Educational Program.
- One (1) additional Special Education Classroom at 950 nsf [1,425 gsf total] to accommodate the District's Special Educational curriculum as noted in the Educational Program.
- Two (2) less Self-Contained SPED Toilets at 60 nsf each [180 gsf total] to accommodate the District's Special Educational curriculum as noted in the Educational Program.
- One (1) additional OT/PT at 950 nsf each [1,425 gsf total] to accommodate the District's Special Educational curriculum as noted in the Educational Program.

Art & Music

- One (1) additional Flexible Performance Space at 2,000 nsf each [3,000 gsf total] to accommodate the District's Performing Arts curriculum as noted in the Educational Program.

Vocations & Technology

- One (1) less Technology/Engineering Rooms at 1,440 nsf each [2,160 gsf total] to accommodate the District's Vocations & Technology curriculum as noted in the Educational Program.
- One (1) additional Tech Shop – Computer Science at 950 nsf each [1,425 gsf total] to accommodate the District's Vocations & Technology curriculum as noted in the Educational Program.
- One (1) additional Tech Shop – Media Arts at 950 nsf each [1,425 gsf total] to accommodate the District's Vocations & Technology curriculum as noted in the Educational Program.

Health & Physical Education

- Increase the Gymnasium 1,600 nsf [2,400 gsf] to accommodate bleacher seating for 250 people.

Media Center

- Decrease the Media Center 690 nsf [1,035 gsf] to redistribute space to accommodate Neighborhood Libraries as noted in the Educational Program.

Dining & Food Service

- Decrease the Cafetorium/Dining 400 nsf [600 gsf] to accommodate space needs for three (3) lunch seating as noted in the Educational Program.

Medical

- One (1) additional Medical Suite Toilet at 60 nsf each [90 gsf total] to accommodate the District's Health Services program needs as noted in the Educational Program.

PRELIMINARY DESIGN PROGRAM, MARCH 2021

Administration & Guidance

- One (1) additional Administration Conference Room at 350 nsf each [525 gsf total] to meet the District's curriculum as noted in the Educational Program.
- One (1) additional Mother's Room at 60 nsf each [90 gsf total] to meet the District's curriculum as noted in the Educational Program.

Other

- One (1) Central Office at 2,900 nsf each [4,350 gsf total] to meet the District's administrative office needs that integral to the Middle School-High School campus operations.
- One (1) District IT Staff at 1,000 nsf each [1,500 gsf total] to meet the District's IT needs that integral to the Middle School-High School campus operations.

(PAGE LEFT INTENTIONALLY BLANK)